



SHERIDAN RANCH

---

# 31st ANNUAL BULL SALE

MARCH 7TH, 2026 • BURLEY IDAHO • 1:00 P.M. MST



CATTLE RAISED IN THE ROCKS

# Welcome

Greetings Cattleman and Cattlewomen

We are excited to bring to you our 31th annual sale. We are pleased with the bull offering this year. The quality keeps getting better every year as we stick to our breeding philosophy. That is to use the best genetics possible without chasing extremes. We stay in the middle of the road on phenotypic traits such as frame size, muscling, and milk. Middle of the road on growth traits in birth weights, weaning weights and yearling weights. By doing so we produce cattle that can thrive in any environment.

We are firm believers in the philosophy of many informed professors and astute Ranchers that they learned by experience. Which is, the most important thing that the commercial cow calf producer can breed for is the cow. The best dollars that a rancher can spend are on genetics that will improve their cow herd. They need a cow that will be an easy keeper and maintain her condition even in challenging times. She needs to calve on time every year and wean a calf that weighs at least 50% of her body weight. Do this every year till she is 10 years old or older. We believe that you need to sell as many high dollar calves as you can. So, if you have to replace a young open cow or have cows calving late in the season, they are costing you money. Fertility and longevity can be bred into your herd by using the right genetics.

This is where the Gelbvieh breed excels. It has been proven that they are one of the most, if not the most fertile breed available. Gelbvieh cross heifers will reach puberty on average 30 days earlier than any other breed. Gelbvieh cross cows will have highest percentage rebred in a 60-day breeding season. Gelbvieh, Balancer cattle never cease to amaze us in our herd how well they breed back and still raise a big calf in moderate condition. We also breed for good carcass traits. Muscling, big rib eyes and marbling. The Gelbvieh and Balancers are one of the few breeds that can do both maternal and terminal in the same mating depending on what you need to do.

We run our cattle like most people do their commercial cows. We run in an environment that is similar to that of most of the intermountain area. Our bulls grow up in the mountains and dry range so it's no adjustment for them to go back. We have reports from ranchers that use our bulls that when they go to their highest roughest range they make sure they have our bulls in the herd, because they know they will go right with cows and maintain their condition and get their job done.

We call this the problem free cattle - bull sale. We have for decades cull for any problems that cost time and extra work. So, we are confident that our genetics will help you on your way to problem free cattle also.

Thanks for your consideration Cordell, Patty & Family



# SHERIDAN RANCH

## *Annual Bull Sale*

Saturday, March 7 2026 - 1:00 PM MST

Burley Livestock Auction, Burley Idaho

Please join us for lunch starting at 12:00

**Owner** Cordell Sheridan  
Phone: (208)430-5532 Email: cordell5532@gmail.com  
Website: www.sheridancattle.com

**Auctioneer** Kade Rogge: (208) 431-0074

**Ringman** Paul Marchant: (208)312-0517  
Merve May (208)431-5735

**Sale Vet** Dr. Trevor Stapelman

**Sale Day Phone** Burley Auction Yard: (208)678-9411

**First Breeding Season Gaurantee** Please refer to our policy in the back of the catalog regarding our ranch first breeding season gatarntee.

**Delivery** We will Deliver free within 300 miles of the sale, or you can recieve a \$50 discount on each lot you buy if you haul them.

**Health** All bulls at sale time will have passed a BSE

We would like to thank Burley Livestock Auction (Lance, Merv and Crew) For their many great years of service and helping us put on this sale.

Thanks to all our family and friends for their continued support. Without them we could not do this.



**DVAuction**  
Broadcasting Real-Time Auctions

Never Miss An Auction Again!  
Watch & Bid online for FREE!

Visit [www.DVAuction.com](http://www.DVAuction.com)  
and Register Today!

For General Questions Please Contact Our Office:  
(402) 316-5460 or support@dvauction.com

# Map and Directions

1100 Occidental Ave | Burley Idaho, 83318

## DIRECTIONS TO SALE

FROM POCATELLO- Continue on I-84 West bound. Take exit 208 and turn left onto Idaho 27/Overland Ave. Go for 2.3 miles then turn right onto W Main St/US 30. Continue for 1/2 a mile and turn right on Occidental Ave, Burley Auction Yard will be on your left.

FROM TWIN FALLS- Continue on I-84 East bound. Take exit 208 and turn right onto Idaho 27/Overland Ave. Go for 2.3 miles then turn right onto W Main St/US 30. Continue for 1/2 a mile and turn right on Occidental Ave, Burley Auction Yard will be on your left.

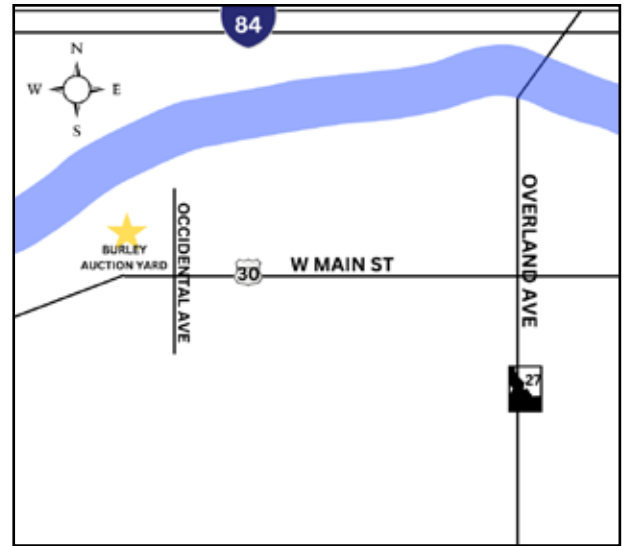

## ACCOMMODATIONS-

Best Western Plus Burley Inn  
(208) 678-3501

Hampton Inn Burley  
(208)878-7040

**VIEW VIDEO CATALOG AND BID LIVE ONLINE WITH SALES MADE EASY.**



**SalesMadeEZ.com**

The **easy** way to run your livestock sale!

### How to Bid Online with SalesMadeEZ

1. Visit **SalesMadeEZ.com** and view your desired sale
2. Click the "Bid Online" button and follow the prompts
3. Start bidding – it's that easy!

# Terms and Conditions

## BIDDING

Each animal offered for sale will be sold to the highest bidder. Each bid shall constitute an offer to purchase and the final bid shall constitute a binding contract between Buyer and Seller. The auctioneer will settle any disputes as to bids and his decision on such matters shall be final.

## TERMS

Terms of the sale are cash or bankable checks. All settlements are to be made with the clerks of the sale immediately following the conclusion of the sale.

## ANNOUNCEMENTS

Any changes from information of any kind in the catalog will be announced from the auction box and such announcements shall take precedence.

## HANDLING & RISK

Each animal will be at Purchaser's risk as soon as sold.

## ADDITIONAL SALE TERMS & CONDITIONS

Any terms and conditions not covered by the catalog will refer to the Standard Sale Terms & Conditions set forth by the American Gelbvieh Association.

## WHAT ARE EPD'S?

Expected Progeny Differences (EPD) may be used to estimate how future progeny sired by the bull can be expected to perform compared to progeny of other sires within the Gelbvieh breed. Information used to calculate EPD's include the individual's own record, pedigree date (sire, dam and grandparents), plus progeny and grand information, if available EPD's are reported in pounds for all traits. Higher Calving Ease EPD's correspond to less calving difficulty. Maternal Calving Ease relates to the ability of daughters to calve. Higher Gestation Length EPD's equal longer gestation of progeny sired by the subject bull. Milk EPD's reflect differences in the weaning weights of progeny of daughters as affected by milk production of the Daughters. Accuracy is reported with EPD's and is a measure of the reliability of the EPD's. Accuracy values can range from 0.0 to 1.0; the closer the value is to 1.0, the more reliable the EPD.

## WHAT EPD'S ARE NOT.

First EPD's do not indicate how many pounds will be added to a herd's average by using a particular bull. Only the differences among bulls are relevant. Second, EPD's can and probably will change on a bull as more information is added. In fact, every bull evaluated will get a new set of EPD's the next time the American Gelbvieh Association conducts another genetic evaluation. Third, EPD's cannot be compared across breeds. Gelbvieh EPD's are not relative to EPD's for bulls from other breeds. And finally, EPD's are one of several tools that should be used together to ensure that you find the best bulls for your needs and long-term goals. Factors such as fertility, structural soundness, muscling and frame size should also be considered. EPD's are the best tools for genetic risk management available today.

## PERFORMANCE TERM

EPD=Expected Progeny Difference

H/P/S = Horned, Polled, Scurred

CED=Calving Ease

HYBRID = an unregistered bull a composite of two or more breeds

BW=Birth Weight

BALANCER = a Gelbvieh, Angus cross that is registered with the Gelbvieh assn.

WW=Weaning Weight

PB GELBVIEH = purebred Gelbvieh

YW=Yearling Weight

MILK=Pounds Due To Milk

SC=Srotal Circumference

**DVAuction**  
www.dvauction.com

Watch & Bid online for FREE!

**Can't make the sale?**

*Let DVAuction bring the sale to you!*

**Busy during the sale?**

*Let DVAuction represent your bid!*

**Visit [www.dvauction.com](http://www.dvauction.com) and Register!**

It's as easy as 1, 2, 3...

1. Create an account at [www.dvauction.com](http://www.dvauction.com) under the "create new account" tab
2. Apply for bidding by clicking "apply for bidding" in the upper left corner of your screen, at least 24 hours prior to the auction
3. Tune into the sale and make your purchases!

For General Questions Please Contact Our Office:  
(402) 316-5460 or [support@dvauction.com](mailto:support@dvauction.com)

\*High Speed Internet Access Required

**Can't make it  
to the Sale? Bid  
from the  
comfort of your  
home.**

**DVAuction**  
**Broadcasting Real-Time Auctions**

# SON OF DEEP CREEK SASQUATCH 3113



Lot 1

## Lot 1 CSG SASQUATCH 32N

2/7/2025 25%GV 75%AN BLACK/POLLED REG#AMGV1649936

MHA STELLAR J73  
DEEP CREEK SASQUATCH 3113  
DEEP CREEK MISS RIPPER 1131  
DEER VALLEY GROWTH FUND

CSG 52K

CSG35E

ADJ. BW	88
ADJ. WW	744
ADJ. YW	1379
ADG.	5.5

CED	BW	WW	YW	MILK	CREA	MAR.B
11	-0.6	76	124	24	0.64	0.53

*32N may be the best bull we have raised. He is sired by our herd bull, SASQUATCH 3113, and out of a 3-year-old cow that is picture perfect, with a great udder, and obviously milks well. 32N is very sound, with good bone on excellent feet and legs. He is thick, deep-bodied and full of red meat. He will complement any herd as he sports a 744 ADJ. 205-day weight and 1379 ADJ. yearling weight. He gained an impressive 5.5 pounds a day on test, on a ration that is geared for 3.25 ADG. He is also one of the calmest bulls in the pen.*



Sire to Lot 1 Deep Creek Sasquatch 3113



SASQUATCH 3113- 2 YEAR OLD

# SON OF ALL AMERICAN



*Lot*  
**2** **CSG ALL AMERICAN 131N**

2/14/2025 99%GV 1%AN BLACK/POLLED REG#AMGV1618472

DLW TPG FRONTRUNNER 2510F  
**ALL AMERICAN J109**  
 CSG F109 ET  
 DCSF POST ROCK MASS APPEAL  
**DCSF POST ROCK TULIP 205A2**  
 DCSF POST ROCK TULIP 94P2

ADJ. BW	81
ADJ. WW	755
ADJ. YW	1384
A.D.G.	3.9

CED	BW	WW	YW	MILK	CREA	MARB
11	0.9	70	101	30	0.65	0.42

*131N is a stud of a bull! He is very well balanced with loads of muscle and red meat. His mother, Tulip 205A2, is a tremendous cow that is 13 years old. She still has a good udder and milks well. 131N has a weaning weight of 755 and yearling weight of 1384. He is sired by the great All American J109 that was one of the heaviest used purebred Gelbvieh bulls in the USA and Canada. He gained 3.9 on test.*



ALL AMERICAN SIRE TO LOTS 2,3,and 4

# SONS OF ALL AMERICAN, GAME CHANGER



## Lot 3 CSG ALL AMERICAN 64N

2/14/2025 87%GV 13%AN BLACK/POLLED REG#AMGV1648460

DLW TPG FRONTRUNNER 2510F  
 ALL AMERICAN J109  
 CSG F109 ET  
 SAM  
 CSG 6H  
 CSG 17F

ADJ. BW	81
ADJ. WW	724
ADJ. YW	1191
A.D.G.	3.6

CED	BW	WW	YW	MILK	CREA	MARB
12	-0.4	75	114	21	0.66	0.47

64N sired by All American J109 a bull that is one of the most used purebred gelbvieh bulls in the USA and around the world. This is an excellent combination of genetics.

## Lot 4 CSG ALL AMERICAN 104N

2/24/2025 99%GV 1%AN BLACK/POLLED REG#AMGV1648471

DLW TPG FRONTRUNNER 2510F  
 ALL AMERICAN J109  
 CSG F109 ET  
 JKG F IMPACT Y353  
 CSG LISA 49E  
 CSG 15W1

ADJ. BW	85
ADJ. WW	739
ADJ. YW	1290
A.D.G.	4.6

CED	BW	WW	YW	MILK	CREA	MARB
14	-0.7	74	107	24	0.64	0.35

104N I really like this bull sired by the great All American and out of 49E, a member of the Lisa cow family. Big weaning and yearling weights on this bull and he gained 4.6 pounds a day on test. To top it off he has one of the best dispositions in the pen.

## Lot 5 CSG GAME CHANGER 20N

2/2/2025 45%GV 55%AN BLACK/POLLED REG#AMGV1648462

BENNETT Y6  
 EGL GAME CHANGER D136  
 DCSF POST ROCK WILMA 118G8  
 SPRING COVE CROSSBOW 36E  
 CSG 20H  
 CSG 105F

ADJ. BW	79
ADJ. WW	664
ADJ. YW	1215
A.D.G.	3.8

CED	BW	WW	YW	MILK	CREA	MARB
11	0.4	77	119	24	0.53	0.47

20N Is sired by the great ELG GAME CHANGER D136. He carries a lot of red meat in an eye 30N 30N this is a nice son of our 107L8 bull. He is siring the right kind. 30N's 11-year-old mother raised him in dry range conditions and weaned him at 712 pounds. 4.3



EGL GAME CHANGER, SIRE TO LOT 5





Lot 6

SCC 24 KARAT, SIRE TO LOT 6



Lot 7

CONNEALY CRAFTSMAN, SIRE TO LOT 7

CSG CRAFTSMAN 121N

2/26/2025 50%GV 50%AN BLACK/POLLED

7AN743 SITZ RESILIENT 10208  
CONNEALY CRAFTSMAN  
BLACK CATHY OF CONAGA 8521  
CSG BOX CAR WILLIE P74 ET

CSG 26H

CSG 26A2

ADJ. BW	83
ADJ. WW	690
ADJ. YW	1139
A.D.G.	2.9

CED	BW	WW	YW	MILK	CREA	MAR.B
10	-0.7	76	135	22	0.26	0.45

121N a craftsman son out 26H from the Twyla cow family, one of the most fertile cow families in our herd. He has good balanced numbers from birth to yearling.



DCFS POST ROCK BIRD DAM TO LOT 6

Lot 8

ZAK WALLSTREET 43N

2/10/2025 50%GV 50%AN BLACK/POLLED

BASIN PAYWEIGHT 1682  
DEER VALLEY WALL STREET  
DEER VALLEY RITA 36113  
DCSF POST ROCK ASTRONAUT 122F1

ZAK 124J

CSG 80A

ADJ. BW	77
ADJ. WW	677
ADJ. YW	1191
A.D.G.	3.8

CED	BW	WW	YW	MILK	CREA	MAR.B
12	-1.2	75	115	21	0.23	0.45

43N is sire by Wall Street a great Angus Bull. Out of one of Zack's best young cows 124J. He will sire growthy steer and the keeping kind of heifers.

Lot 6

CSG 24 KARAT 6N ET

1/26/2025 20%GV 80%AN BLACK/POLLED REG#AMGV1649746

SCC TRADITION OF 24  
SCC SCH 24 KARAT  
FCF PROVEN QUEEN 419  
BASIN PAYWEIGHT 1682  
DCFS POST ROCK BIRD 47E8  
POST ROCK BIRD 139B2

ADJ. BW	84
ADJ. WW	553
ADJ. YW	976
A.D.G.	2.7

CED	BW	WW	YW	MILK	CREA	MAR.B
10	1.8	82	131	24	0.4	0.41

6N is a unique bull. He is an embryo transplant from our Bird 47E8 cow, who is a beautiful moderate frame very deep bodied cow. Sired by the 24 Karate bull who has extra thickness and muscling, he sires very attractive eye appealing cattle as well. His receipt mother wasn't the best milk producer, so he weaned a little light but has gained and filled out really well since. He will sire the kind of steers that could top the market.



Lot 8



Lot 10

*Lot*  
**9** CSG SEMINOLE WIND 33N

2/8/2025 99%GV 1%AN BLACK/POLLED REG#AMGV164869

EXACT COMBINATION E409  
RWG SEMINOLE WIND 9430 ET  
KITTY'S DREAM D526  
KANSAS DCSF POST ROCK WESTERN 143Y1  
CSG JENNY 15C  
CSG 49W

ADJ. BW	86
ADJ. WW	662
ADJ. YW	1183
A.D.G.	3.5

CED	BW	WW	YW	MILK	CREA	MAR.B
12	0	72	102	21	0.52	0.12

33N Sired by Seminole Wind 9430, the popular Gelbvieh bull from Canada that brings performance and the maternal excellence of the Kitty cow family. 33N's dam Jenny 15C has always been a standout cow. She proved her maternal excellence at 11 years of age with 33N weaning him at 803 pounds coming off dry range. 33N will be a cow maker.

*Lot*  
**11** CSG SEMINOLE WIND 48N

2/11/2025 75%GV 25%AN BLACK/POLLED REG#AMGV1648470

EXACT COMBINATION E409  
RWG SEMINOLE WIND 9430 ET  
KITTY'S DREAM D526  
PGF TEASDALE 918  
CSG 91A  
CSG 6P

ADJ. BW	86
ADJ. WW	735
ADJ. YW	1168
A.D.G.	3.0

CED	BW	WW	YW	MILK	CREA	MAR.B
10	0.5	72	108	20	0.47	0.38

48N a son of Seminole Wind 9430 and out of one of my best older cows 91A. She raised him on the mountain and weaned him off at 774 pounds at 13 years of age.

*Lot*  
**10** CSG SEMINOLE WIND 38N

2/9/2025 88%GV 12%AN BLACK/POLLED REG#AMGV164864

EXACT COMBINATION E409  
RWG SEMINOLE WIND 9430 ET  
KITTY'S DREAM D526  
DCSF POST ROCK STOCKADE 183A8  
CSG ROSE 73B  
CSG 71Y

ADJ. BW	83
ADJ. WW	637
ADJ. YW	1159
A.D.G.	3.8

CED	BW	WW	YW	MILK	CREA	MAR.B
10	0.5	74	108	20	0.5	0.21

38N Sired by Seminole Wind 9430 and out of one of my favorite cows Rose 73B. Rose raised this stud of a bull at 12 years of age. 38N has always been a standout bull since he was born.



# SONS OF POST ROCK BLK BAL 107L8



DCSF POST ROCK BLK BAL, SIRE TO 16-20

## Let 12 CSG 107L8 BAL 30N

2/5/2025 50%GV 50%AN BLACK/POLLED

DCSF POST ROCK BLK BAL 107L8  
 POST ROCK WILMA 118G8  
 MYTTY IN FOCUS  
 CSG 94A

ADJ. BW	84
ADJ. WW	644
ADJ. YW	1169
A.D.G.	4.3

CED	BW	WW	YW	MILK	CREA	MARB
9	1.1	84	136	20	0.5	0.35

30N This is a nice son of our 107L8 bull he is siring the right kind. 30N's 11-year-old mother raised him in dry range conditions and weaned him at 712 pounds. 4.3 ADG.

## Let 13 CSG 107L8 BAL 99N

2/20/2025 63%GV 37%AN BLACK/POLLED REG#AMGV1649802

DCSF POST ROCK BLK BAL 107L8  
 POST ROCK WILMA 118G8  
 CSG GEORGIA 71G ET  
 CSG ELBA 82J  
 CSG ELBA 114E

ADJ. BW	83
ADJ. WW	731
ADJ. YW	1017
A.D.G.	2.2

CED	BW	WW	YW	MILK	CREA	MARB
9	1.1	80	128	21	0.59	0.34

99N is a 107L8 son out of 78J a member of the Elba cow family. One of our best producing cow families. This a maternal pedigree, keep all his heifers.

## Let 14 CSG 107L8 BAL 134N

3/2/2025 50%GV 50%AN BLACK/POLLED

DCSF POST ROCK BLK BAL 107L8  
 DCSF POST ROCK WILMA  
 DCSF POST ROCK SUPER TRACKER 76B1 ET  
 CSG 150H  
 CSG 78Y

ADJ. BW	87
ADJ. WW	627
ADJ. YW	1127
A.D.G.	3.5

CED	BW	WW	YW	MILK	CREA	MARB
9	1.3	65	131	21	0.62	0.55

134N is sired by 107L8, our standout young herd bull that came from the Post Rock Program. 107L8 gained so well that he had their highest Yearling weight that year. He is a moderate framed bull but is thick and deep. 134N is out of one of our better young cows.

## Let 15 CSG 107L8 BAL 138N

3/5/2025 75%GV 25%AN BLACK/POLLED

DCSF POST ROCK BLK BAL 107L8  
 POST ROCK WILMA 118G8  
 POST ROCK SUPER TRACKER 76B1 ET  
 CSG 66J  
 CSG 9Z

ADJ. BW	90
ADJ. WW	680
ADJ. YW	1196
A.D.G.	3.8

CED	BW	WW	YW	MILK	CREA	MARB
10	0.8	88	140	20	0.59	0.37

138N is a good 107L8 son and out of a really nice Super Tracker daughter.





Lot 18

*Lot*  
**16** CSG 107L8 BAL 147N

3/7/2025 75%GV 25%AN BLACK/POLLED

DCSF POST EGL GAME CHANGER D136  
ROCK BLK BAL 107L8  
POST ROCK WILMA 118G8  
DCSF POST ROCK ASTRONAUT 157A  
CSG 58F  
CSG 118Y

ADJ. BW	86
ADJ. WW	648
ADJ. YW	1136
A.D.G.	3.7

CED	BW	WW	YW	MILK	CREA	MAR.B
10	0.4	81	142	22	0.52	0.41

147N a 107L8 son and out of 58F, daughter of the famous 118Y cow. He is a bull that will sire attractive growthy steers and heifers that will improve your herd.



Lot 20

*Lot*  
**17** CSG 107L8 BAL 152N

3/8/2025 50%GV 50%AN BLACK/POLLED

DCSF POST EGL GAME CHANGER D136  
ROCK BLK BAL 107L8  
POST ROCK WILMA 118G8  
62E  
CSG 90H  
CSG 68C

ADJ. BW	76
ADJ. WW	678
ADJ. YW	1150
A.D.G.	4.0

CED	BW	WW	YW	MILK	CREA	MAR.B
10	0.2	81	130	23	0.55	0.34

152N a son of 107L8 out of the 90H cow, a great combination of genetics. 152N has good numbers and gained 4.0 on test.

*Lot*  
**18** CSG 107L8 BAL 150N

3/7/2025 75%GV 25%AN BLACK/POLLED

DCSF POST EGL GAME CHANGER D136  
ROCK BLK BAL 107L8  
DCSF POST ROCK WILMA  
DCSF POST ROCK ASTRONAUT 157A  
CSG 32C  
CSG 62Y

ADJ. BW	81
ADJ. WW	729
ADJ. YW	1237
A.D.G.	3.8

CED	BW	WW	YW	MILK	CREA	MAR.B
9	1.6	76	114	18	0.49	0.36

150N is a super bull sired by 107L8 and our of one my favorite cows 32C. she is an Astronaut 157A daughter that always raises a good one. 150N has a weaning weight of 729 and yearling of 1237.

*Lot*  
**19** CSG 107L8 BAL 173N

3/30/2025 50%GV 50%AN BLACK/POLLED

DCSF POST EGL GAME CHANGER D136  
ROCK BLK BAL 107L8  
POST ROCK WILMA 118G8  
DCFS POST ROCK ASTRONAUT 122F1  
CSG 17H  
CSG 28C

ADJ. BW	77
ADJ. WW	684
ADJ. YW	1221
A.D.G.	2.9

CED	BW	WW	YW	MILK	CREA	MAR.B
11	-0.1	75	136	20	0.62	0.44

173N a son of 107L8 out of a good young cow he has a BW 77 WW 654 YW 1221

*Lot*  
**20** CSG 107L8 BAL 174N

3/26/2025 50%GV 50%AN BLACK/POLLED

DCSF POST EGL GAME CHANGER D136  
ROCK BLK BAL 107L8  
POST ROCK WILMA 118G8  
BUTKUS 5E  
CSG 7H  
CSG 16F

ADJ. BW	79
ADJ. WW	757
ADJ. YW	1386
A.D.G.	4.9

CED	BW	WW	YW	MILK	CREA	MAR.B
10	0.4	84	142	23	0.61	0.39

174N is a 107L8 son out of a super young cow 7H. he has a BW 79 WW 757 YW 1386. He gained 4.9 on test.



# SONS OF DEEP CREEK SASQUATCH 3113



DEEP CREEK SASQUATCH, SIRE TO LOTS 21-30

## Lot 21 CSG SASQUATCH 39N

2/9/2025 20%GV 80%AN BLACK/POLLED REG#AMGV1649938

MHA STELLAR J73  
DEEP CREEK SASQUATCH 3113  
DEEP CREEK MISS RIPPER 1131  
PROBITY  
CSG F9J  
TJB 220

ADJ. BW	75
ADJ. WW	727
ADJ. YW	1042
A.D.G.	3.0

CED	BW	WW	YW	MILK	CREA	MARB
12	-0.4	68	108	24	0.65	0.47

39N is a very good son of Sasquatch 3113 and out of a Probity daughter. 39N is a curve bender with a 77 BW and 772 WW. Breed leading genetics here.

## Lot 22 CSG SASQUATCH 60N

2/16/2025 50%GV 50%AN BLACK/POLLED REG#AMGV1648937

MHA STELLAR J73  
DEEP CREEK SASQUATCH 3113  
DEEP CREEK MISS RIPPER 1131  
CSG SURE FIRE 45G  
CSG 94K  
CSG 6H

ADJ. BW	71
ADJ. WW	700
ADJ. YW	1083
A.D.G.	3.4

CED	BW	WW	YW	MILK	CREA	MARB
13	-0.7	68	114	24	0.55	0.35

60N is sired by Sasquatch 3113 out of a great young cow 94K. He weaned at 722 pounds. 60N will work on heifers.

## Lot 23 CSG SASQUATCH 76N

2/16/2025 25%GV 75%AN BLACK/POLLED REG#AMGV1649660

MHA STELLAR J73  
DEEP CREEK SASQUATCH 3113  
DEEP CREEK MISS RIPPER 1131  
EXAR RESISTOL 3710B  
CSG 26K  
CSG 36B

ADJ. BW	79
ADJ. WW	617
ADJ. YW	1103
A.D.G.	3.7

CED	BW	WW	YW	MILK	CREA	MARB
11	-0.7	70	107	24	0.54	0.57

76N this is a good light birth weight son of Sasquatch 3113. He has an ADJ. yearling weight over 1100 pounds.

## Lot 24 CSG SASQUATCH 92N

2/18/2025 50%GV 50%AN BLACK/POLLED REG#AMGV1649662

MHA STELLAR J73  
DEEP CREEK SASQUATCH 3113  
DEEP CREEK MISS RIPPER 1131  
RESISTOL  
CSG 58K  
CSG 33C

ADJ. BW	81
ADJ. WW	666
ADJ. YW	1177
SC	38
A.D.G.	3.6

CED	BW	WW	YW	MILK	CREA	MARB
11	1.8	68	119	24	0.55	0.47

92N is a good looking Sasquatch son. He has an adjusted yearling weight of 1197.

## Lot 25 CSG SASQUATCH 101N

2/22/2025 50%GV 50%AN BLACK/POLLED REG#AMGV1649664

MHA STELLAR J73  
DEEP CREEK SASQUATCH 3113  
DEEP CREEK MISS RIPPER 1131  
CSG GEORGIA 71G ET  
CSG 30K  
CSG 16F

ADJ. BW	73
ADJ. WW	687
ADJ. YW	1112
A.D.G.	3.4

CED	BW	WW	YW	MILK	CREA	MARB
12	-0.3	70	114	23	0.4	0.47

101N a light birth weight son of Sasquatch. He is out of a great cow family. He is heifer worthy.

## Lot 26 CSG SASQUATCH 108N

2/24/2025 50%GV 50%AN BLACK/POLLED REG#AMGV1649665

MHA STELLAR J73  
DEEP CREEK SASQUATCH 3113  
DEEP CREEK MISS RIPPER 1131  
CSG GEORGIA 71G ET  
CSG 138K  
CSG 54D

ADJ. BW	86
ADJ. WW	693
ADJ. YW	1132
A.D.G.	5.2

CED	BW	WW	YW	MILK	CREA	MARB
11	-0.8	70	119	24	0.53	0.47

108N is a good Sasquatch son out 138K. 138K's mother is a good cow sired by Georgia 71G, a good solid cow.



Lot 28



LOT 28 AS A CALF

**Lot 27 CSG SASQUATCH 119N**  
 2/25/2025 50%GV 50%AN BLACK/POLLED REG#AMGV1649666

MHA STELLAR J73  
 DEEP CREEK SASQUATCH 3113  
 DEEP CREEK MISS RIPPER 1131  
 THOR  
 CSG 80K  
 CSG 33A

ADJ. BW	85
ADJ. WW	645
ADJ. YW	1201
A.D.G.	3.9

CED	BW	WW	YW	MILK	CREA	MARB
11	0.4	77	120	24	0.54	0.12

119N is a Sasquatch son out of 80K, a nice cow. She raised 119N as her second calf. He has good balanced weights, and he has a ADG. Of 3.9 on the bull test.

**Lot 28 CSG SASQUATCH 154N**  
 3/13/2025 25%GV 75%AN BLACK/POLLED REG#AMGV1649670

MHA STELLAR J73  
 DEEP CREEK SASQUATCH 3113  
 DEEP CREEK MISS RIPPER 1131  
 CSG GEORGIA 71G ET  
 CSG 17K  
 CSG 32G

ADJ. BW	78
ADJ. WW	727
ADJ. YW	1263
A.D.G.	3.6

CED	BW	WW	YW	MILK	CREA	MARB
13	0.3	78	102	24	0.52	0.51

154N is a stud, sired by Sasquatch, and out of a good young Georgia 71G daughter, 17K. 154N has a 727 WW and a 1263 YW. He has been a standout since birth.

**Lot 29 CSG SASQUATCH 184N**  
 3/25/2025 50%GV 50%AN BLACK/POLLED REG#AMGV1648939

MHA STELLAR J73  
 DEEP CREEK SASQUATCH 3113  
 DEEP CREEK MISS RIPPER 1131  
 DLW TPG FRONTRUNNER 2510F  
 CSG TWILA 68K  
 CSG 26A2

ADJ. BW	80
ADJ. WW	738
ADJ. YW	1381
A.D.G.	4.1

CED	BW	WW	YW	MILK	CREA	MARB
11	0	72	108	21	0.42	0.21

184N is out of the super Twila 68K cow. She was the mother of our lot 1 bull last year that sold to Vance Dill. 68K is proving that last year was not a fluke and raised another good one. 184N is sired by Sasquatch 3113 a bull we bought from Dennis Timm in Utah. 184N has a BW 80 WW 738 YW 1381 and gained 4.1 on test. Herd bull deluxe.

**Lot 30 CSG SASQUATCH 204N**  
 3/20/2025 100%AN BLACK/POLLED REG#AMGV1649681

MHA STELLAR J73  
 DEEP CREEK SASQUATCH 3113  
 DEEP CREEK MISS RIPPER 1131  
 SAV PRESIDENT  
 CSG DONNA F8J  
 COLEMAN DONNA 3202

ADJ. BW	78
ADJ. WW	752
ADJ. YW	1156
A.D.G.	4.4

CED	BW	WW	YW	MILK	CREA	MARB
10	0.5	75	110	24	0.4	0.38

204N is a purebred Angus. Sired by Sasquatch 3113 and out of Donna F8J. F8J is an ET cow originating from the well known Coleman Angus operation. 204N has BW 78 WW 752 YW 1156.



Lot 29

*Lot*  
**31** CSG SASQUATCH 196N

3/19/2025 50%GV 50%AN BLACK/POLLED REG#AMGV1649680

MHA STELLAR J73  
DEEP CREEK SASQUATCH 3113  
DEEP CREEK MISS R 1131  
DCSF POST ROCK ASTRONAUT 122F1  
CSG 35K  
CSG 37B

ADJ. BW	81
ADJ. WW	666
ADJ. YW	1177
A.D.G.	3.7

CED	BW	WW	YW	MILK	CREA	MARB
12	-0.5	68	108	24	0.47	0.52

196N is sired by Sasquatch 3113, and out of a good 3 year old cow 35K. he has good balanced numbers.

*Lot*  
**32** CSG SASQUATCH 207N

3/15/2025 100%AN BLACK/POLLED

MHA STELLAR J73  
DEEP CREEK SASQUATCH 3113  
DEEP CREEK MISS RIPPER 1131  
TRACTION  
CSG JANNET 30E  
CSG JANNET 13R

ADJ. BW	81
ADJ. WW	726
ADJ. YW	1248
SC	38
A.D.G.	3.3

CED	BW	WW	YW	MILK	CREA	MARB
12	-1.2	80	130	26	1.5	0.93

207N is a purebred Angus. A Sasquatch 3113 son, and out of Jannet 30E a daughter of Autumn's cow Jannet 13R, a super Angus cow family. 207N has a BW 81 WW 726 YW 1248

*Lot*  
**33** CSG SASQUATCH 208N

4/3/2025 25%GV 75%AN BLACK/POLLED REG#AMGV1649151

MHA STELLAR J73  
DEEP CREEK SASQUATCH 3113  
DEEP CREEK MISS RIPPER 1131  
PGF TEASDALE 918  
CSG WANDA 107Y  
CSG 21W

ADJ. BW	81
ADJ. WW	662
ADJ. YW	1271
A.D.G.	3.8

CED	BW	WW	YW	MILK	CREA	MARB
11	-0.7	68	108	21	0.66	0.52

208N is a great balancer bull. Sired by Sasquatch 3113 and out of a 15 year old cow Wanda 107Y. his weights BW 81 WW 662 YW 1271.

*Lot*  
**34** CSG SAND TRAP 218N

4/3/2025 50%GV 50%AN BLACK/POLLED

SAND TRAP ET  
TAYD 321A SAND TRAP 206K ET  
LADY GRANITE 321A ET

ADJ. BW	81
ADJ. WW	662
ADJ. YW	1271
A.D.G.	3.0

CED	BW	WW	YW	MILK	CREA	MARB
11	0.3	66	98	22	0.45	0.42

218N is a real good Sand Trap son out of an eye appealing cow B106

*Lot*  
**35** CSG SASQUATCH 226N

4/4/2025 25%GV 75%AN BLACK/POLLED REG#AMGV1649682

MHA STELLAR J73  
DEEP CREEK SASQUATCH 3113  
DEEP CREEK MISS RIPPER  
DCSF POST ROCK ASTRONAUT 122F1  
CSG 151H  
CSG 67Y

ADJ. BW	84
ADJ. WW	713
ADJ. YW	1159
A.D.G.	3.2

CED	BW	WW	YW	MILK	CREA	MARB
14	0.5	70	108	18	0.56	0.38

226N is a Sasquatch 3113 son out of good young cow 151H. He has a 713 WW and a 1159 YW.



# SONS OF CSG GALACTIC 140K



Lot 41



CSG GALACTIC 140K

## Lot 36 CSG GALACTIC 73N

2/15/2025 50%GV 50%AN BLACK/POLLED REG#AMGV1649155

DCSF POST ROCK ASTRONAUT 122F1  
CSG GALACTIC 140K  
CSG ELBA 114E  
KANSAS DCSF POST ROCK WESTERN 143Y1  
CSG 54D  
CSG 43T

ADJ. BW	84
ADJ. WW	630
ADJ. YW	1126
A.D.G.	4.7

CED	BW	WW	YW	MILK	CREA	MARB
12	1.8	69	120	21	0.56	0.58

I really like this bulls mother. She is 10 years old and still raising good ones. 73N has good solid weaning and yearling numbers. He excelled in our gain test and averaged 4.7 pounds a day.

## Lot 37 CSG GALACTIC 90N

2/17/2025 100%GV BLACK/POLLED REG#AMGV1648468

DCSF POST ROCK ASTRONAUT 122F1  
CSG GALACTIC 140K  
CSG ELBA 114E  
KANSAS DCSF POST ROCK WESTERN 143Y1  
CSG G 7B  
CSG 25S

ADJ. BW	84
ADJ. WW	714
ADJ. YW	1100
A.D.G.	2.8

CED	BW	WW	YW	MILK	CREA	MARB
9	1.9	68	96	18	0.56	0.22

90N has ADJ weaning and yearling weights of 714 and 1100. He is a good Galactic son.

## Lot 38 CSG GALACTIC 95N

2/19/2025 99%GV 1%AN BLACK/POLLED

DCSF POST ROCK ASTRONAUT 122F1  
CSG GALACTIC 140K  
CSG ELBA 114E  
CSG BOX CAR WILLIE P74 ET  
CSG QUEEN 9C  
CSG QUEEN 16Z

ADJ. BW	73
ADJ. WW	590
ADJ. YW	1125
A.D.G.	4.1

CED	BW	WW	YW	MILK	CREA	MARB
810	-0.02	65	94	20	0.48	0.21

95N was a twin calf to a heifer. He is a son of Queen 9C she raised our high selling bull in 2024. His mother claimed the heifer calf and not him so he was raised by a first calf heifer that lost a calf. The genetics are here he just didn't have the groceries to realize his full potential.

## Lot 39 ZAK GALACTIC 129N

3/1/2025 100%GV BLACK/POLLED

DCSF POST ROCK ASTRONAUT 122F1  
CSG GALACTIC 140K  
CSG ELBA 114E  
TEASDALE  
ZAK 62A  
CSG 49J

ADJ. BW	88
ADJ. WW	693
ADJ. YW	1178
A.D.G.	4.1

CED	BW	WW	YW	MILK	CREA	MARB
10	0.2	71	95	20	0.45	0.31

129N is a Galactic son out of a 13 year old cow. She weaned him coming off the mountain at 693 pounds. Longevity is a valuable trait. He gained 4.1 a day on test.

## Lot 40 CSG GALACTIC 130N

3/1/2025 99%GV 1%AN BLACK/POLLED

DCSF POST ROCK ASTRONAUT 122F1  
CSG GALACTIC 140K  
CSG ELBA 114E  
DCSF POST ROCK PASSION 160Z1  
CSG 83B  
CSG 49W

ADJ. BW	82
ADJ. WW	606
ADJ. YW	1024
A.D.G.	2.7

CED	BW	WW	YW	MILK	CREA	MARB
12	-0.2	72	102	19	0.51	0.39

130N is a Galactic son out of one of my favorite old cows 83B she is 12 years old. She has many daughters and Granddaughters in our herd.

## Lot 41 CSG GALACTIC 145N

3/6/2025 88%GV 12%AN BLACK/POLLED REG#AMGV1648465

DCSF POST ROCK ASTRONAUT 122F1  
CSG GALACTIC 140K  
CSG ELBA 114E  
DCSF POST ROCK STOCKADE 183A8  
CSG 39C  
CSG 26Z

ADJ. BW	83
ADJ. WW	710
ADJ. YW	1210
A.D.G.	4.6

CED	BW	WW	YW	MILK	CREA	MARB
9	1.8	69	97	18	0.55	0.24

145N is a Galactic son out of a great old cow 39C she is 11 years old and weaned him at 710 pounds. He has a yearling weight of 1210.

# SONS OF CSG GALACTIC 140K



## Lot 42 CSG GALACTIC 146N

3/7/2025 99%GV 1%AN BLACK/POLLED

DCSF POST ROCK ASTRONAUT 122F1  
CSG GALACTIC 140K  
CSG ELBA 114E  
CSG BOX CAR WILLIE P74 ET  
CSG QUEEN 16Z  
CSG 70T

ADJ. BW	87
ADJ. WW	735
ADJ. YW	1142
A.D.G.	3.6

CED	BW	WW	YW	MILK	CREA	MARB
14	-1.2	60	89	23	0.29	0.34

146N is a Galactic son out a great cow Queen 16Z. 16Z is 15 years old and still raising good ones. 146N has a weaning weight of 735. This one is a herd bull.

## Lot 43 CSG GALACTIC 167N

3/30/2025 75%GV 25%AN BLACK/POLLED

DCSF POST ROCK ASTRONAUT 122F1  
CSG GALACTIC 140K  
CSG ELBA 114E  
DCSF POST ROCK STOCKADE 183A8  
CSG 123G  
CSG 75C

ADJ. BW	77
ADJ. WW	763
ADJ. YW	1190
A.D.G.	4.0

CED	BW	WW	YW	MILK	CREA	MARB
12	-0.5	66	94	22	0.56	0.38

167N a Galactic son that has a birth weight of 77 and an adj. w.w. of 763.

## Lot 44 CSG GALACTIC 175N

3/27/2025 99%GV 1%AN BLACK/POLLED REG#AMGV1648466

DCSF POST ROCK ASTRONAUT 122F1  
CSG GALACTIC 140K  
CSG ELBA 114E  
JKGF IMPACT Y353  
CSG 44D  
CSG 101R

ADJ. BW	84
ADJ. WW	797
ADJ. YW	1257
A.D.G.	3.6

CED	BW	WW	YW	MILK	CREA	MARB
9	1.8	70	97	19	0.56	0.23

175N out of a 10 year old cow that really milks well and breeds on time every year. He has a WW of 797 and YW of 1257.

## Lot 45 CSG GALACTIC 176N

3/2/2025 75%GV 25%AN BLACK/POLLED REG#AMGV1648467

DCSF POST ROCK ASTRONAUT 122F1  
CSG GALACTIC 140K  
CSG ELBA 114E  
LIL TRACKER  
CSG 4F  
CSG 47D

ADJ. BW	88
ADJ. WW	816
ADJ. YW	1307
A.D.G.	4.2

CED	BW	WW	YW	MILK	CREA	MARB
9	1.6	70	100	19	0.54	0.27

176N is a stud. He is a Galactic son out a great cow family his mother is 4F has a WW of 816 and a YW of 1307. He gained 4.2 on test.

## Lot 46 CSG GALACTIC 209N

4/3/2025 25%GV 75%AN BLACK/POLLED

DCSF POST ROCK ASTRONAUT 122F1  
CSG GALACTIC 140K  
CSG ELBA 114E  
CONNEALY CONSENSUS 7229  
CSG 36A  
CSG 101R

ADJ. BW	85
ADJ. WW	705
ADJ. YW	1233
A.D.G.	3.5

CED	BW	WW	YW	MILK	CREA	MARB
13	-1.1	65	95	21	0.59	0.62

209N is a Galactic son and out a cow with great longevity. He has a BW 85 WW 705 YW 1233.

## Lot 47 ZAK GALACTIC 5N

3/16/2025 50%GV 50%AN BLACK/POLLED

DCSF POST ROCK ASTRONAUT 122F1  
CSG GALACTIC 140K  
CSG ELBA 114E  
CSG SURE FIRE 45G  
ZAK 124K  
CSG 1H

ADJ. BW	91
ADJ. WW	660
ADJ. YW	1160
A.D.G.	3.7

CED	BW	WW	YW	MILK	CREA	MARB
12	-0.3	64	101	23	0.58	0.25

5N is a moderate framed easy keeping kind of a bull. He should sire some low maintenance quality cattle. He is a Galactic son out of good cow 124K.

# SONS OF CSG SURE FIRE 45G



CSG SURE FIRE 45G

*Lel*  
**48** CSG SURE FIRE 7N  
1/27/2025 53%GV 47%AN BLACK/POLLED REG#AMGV1648583

CSG SURE FIRE 45G  
GAR SURE FIRE  
CSG MISS RESOLUTE 22E  
FUTURE INVESTMENT  
CSG 70D  
CSG 9U

ADJ. BW	58
ADJ. WW	632
ADJ. YW	1183
A.D.G.	3.44

CED	BW	WW	YW	MILK	CREA	MARB
15	-0.3	70	108	23	0.4	0.58

7N is a thick, deep bodied bull. His mother has a perfect udder. I am confident he will sire exceptional daughters and the kind of steers that will top the market. He averaged 4.2 pounds a day on test.

*Lel*  
**50** CSG SURE FIRE 34N  
2/8/2025 65%GV 35%AN BLACK/POLLED REG#AMGV1648579

CSG SURE FIRE 45G  
GAR SURE FIRE  
CSG MISS RESOLUTE 22E  
Y353  
CSG 54D  
CSG 45Y

ADJ. BW	870
ADJ. WW	721
ADJ. YW	1222
A.D.G.	3.13

CED	BW	WW	YW	MILK	CREA	MARB
14	-0.5	68	108	24	0.42	0.51

34N is a great son of Sure Fire 45G and out of a good producing cow 54D that is 10 years old and weaned 34N at 790 pounds. 34N is an awesome combination of carcass and maternal genetics.

*Lel*  
**49** CSG SURE FIRE 16N  
2/1/2025 50%GV 50%AN BLACK/POLLED REG#AMGV1648578

CSG SURE FIRE 45G  
GAR SURE FIRE  
CSG MISS RESOLUTE 22E  
FOCUS 0017  
CSG 36B  
CSG 21P

ADJ. BW	86
ADJ. WW	695
ADJ. YW	1115
A.D.G.	2.93

CED	BW	WW	YW	MILK	CREA	MARB
14	-0.8	70	114	24	0.4	0.57

16N is out of a 12-year-old cow that looks like she is 6. He weaned off at 758 pounds with an adj. 205 of 695. His sire has a marbling EPD of .82, that is in the top 2% of the breed.

*Lel*  
**51** CSG SURE FIRE 40N  
3/5/2025 63%GV 37%AN BLACK/POLLED REG#AMGV1648580

CSG SURE FIRE 45G  
GAR SURE FIRE  
CSG MISS RESOLUTE 22E  
DCSF POST ROCK ASTRONAUT 122F1  
CSG 25H  
148C

ADJ. BW	90
ADJ. WW	680
ADJ. YW	555
A.D.G.	2.96

CED	BW	WW	YW	MILK	CREA	MARB
14	-0.7	70	110	24	0.43	0.52

40N is a son of Sure Fire 45G who ranks in the top 2% for marbling in the breed. 40N is a good looking bull with balanced numbers from CED to YW.





Lot 54

*Lot*  
**53** CSG SURE FIRE 56N

2/12/2025 50%GV 50%AN BLACK/POLLED REG#AMGV1649154

GAR SURE FIRE  
CSG SURE FIRE 45G  
CSG MISS RESOLUTE 22E  
DCSF POST ROCK ASTRONAUT 157A  
CSG 23F  
CSG 26A2

ADJ. BW	85
ADJ. WW	569
ADJ. YW	1151
A.D.G.	4.2

CED	BW	WW	YW	MILK	CREA	MAR.B
11	1.9	75	109	24	0.59	0.22

56N is sired by Sure Fire 45G and is out of 23F, a member of the Twyla Cow family. The Twyla lineage is recognized as one of the most fertile cow families in our herd. During performance testing, 56N demonstrated impressive growth, gaining 4.2 pounds per day.

*Lot*  
**56** CSG SURE FIRE 74N

2/15/2025 75%GV 25%AN BLACK/POLLED

GAR SURE FIRE  
CSG SURE FIRE 45G  
CSG MISS RESOLUTE 22E  
DCSF POST ROCK PASSION 160Z1  
CSG 49D  
CSG 57U

ADJ. BW	85
ADJ. WW	611
ADJ. YW	1138
A.D.G.	4.4

CED	BW	WW	YW	MILK	CREA	MAR.B
15	-1.2	72	118	23	0.35	0.75

174N is a 107L8 son out of a young cow 7H. he has a BW 79 WW 757 YW 1386. He gained 4.9 on test

*Lot*  
**54** CSG SURE FIRE 58N

2/13/2025 50%GV 50%AN BLACK/POLLED REG#AMGV1648581

GAR SURE FIRE  
CSG SURE FIRE 45G  
CSG MISS RESOLUTE 22E  
BUTKUS 5E  
CSG 17E  
CSG 148C

ADJ. BW	83
ADJ. WW	723
ADJ. YW	1274
A.D.G.	4.2

CED	BW	WW	YW	MILK	CREA	MAR.B
14	-0.6	68	109	24	0.4	0.53

58N is one of our standout bulls. Sired by Sure Fire 45G and out of 17E. He weaned off at 776 pounds. 4.2 ADG on test.

*Lot*  
**57** CSG SURE FIRE 81N

2/16/2025 75%GV 25%AN BLACK/POLLED

GAR SURE FIRE  
CSG SURE FIRE 45G  
CSG MISS RESOLUTE 22E  
DCSF POST ROCK ASTRONAUT 122F1  
CSG 78J  
CSG 49W

ADJ. BW	85
ADJ. WW	662
ADJ. YW	1063
A.D.G.	2.51

CED	BW	WW	YW	MILK	CREA	MAR.B
13	-1.3	70	115	22	0.3	0.6

81N is sired by Sure Fire 45G and out of a 78J. 78J is a member of one of our best cow families.



# SONS OF TAYD 321A SAND TRAP



TAYD 321A SAND TRAP 206K

*Lel* **52** **CSG SAND TRAP 49N**  
 2/11/2025 50%GV 50%AN BLACK/POLLED

SAND TRAP ET  
 TAYD 321A SAND TRAP 206K ET  
 LADY GRANITE 321A ET

CSG B13

ADJ. BW	81
ADJ. WW	552
ADJ. YW	1133
A.D.G.	3.4

CED	BW	WW	YW	MILK	CREA	MAR.B
13	-0.12	58	85	20	0.33	0.34

49N is a Sand Trap 206k son. The first calf crop of Sand Trap 260K has not disappointed, they have extra muscle in a moderate package.

*Lel* **58** **CSG SAND TRAP 123N**  
 2/27/2025 50%GV 50%AN BLACK/POLLED

SAND TRAP ET  
 TAYD 321A SAND TRAP 206K ET  
 LADY GRANITE 321A ET

CSG B3

ADJ. BW	87
ADJ. WW	672
ADJ. YW	1063

CED	BW	WW	YW	MILK	CREA	MAR.B
12	0.2	60	94	20	0.3	0.29

49N is a Sand Trap 206K son. The first calf crop of Sand Trap 260K has not disappointed, they have extra muscle in a moderate package.

*Lel* **59** **CSG SAND TRAP 127N**  
 3/1/2025 99%GV 1%AN BLACK/POLLED

SAND TRAP ET  
 TAYD 321A SAND TRAP 206K ET  
 LADY GRANITE 321A ET

CSG B156

CSG Y156

ADJ. BW	83
ADJ. WW	599
ADJ. YW	1147

CED	BW	WW	YW	MILK	CREA	MAR.B
10	0.5	62	98	21	1.26	0.37

127N is sired by TJB SAND TRAP 206K, a bull we acquired from TJB Gelbvieh in Georgia. He is a moderate framed bull with loads of muscle and thickness. 127N gained 3.9 on test.

*Lel* **60** **CSG BLUE SKY 136N**  
 3/2/2025 63%GV 37%AN BLACK/POLLED REG#AMGV1648461

BLUE'S IMPACT 001X  
 ZA BLUE SKY 6J ET  
 ANISSA 92U ET  
 DLW TPG FRONTRUNNER 2510F

CSG 60L

CSG JANNET 30E

ADJ. BW	87
ADJ. WW	714
ADJ. YW	1160

CED	BW	WW	YW	MILK	CREA	MAR.B
12	-0.7	68	102	24	0.59	0.25

136N is sired by our heifer bull 6J and out of great little first calf heifer 60L. 60L did a great job as 136N has 714 weaning weight and 1160 yearling weight.



# TWO YEAR OLD BULLS

## Lot 61 CSG SURE FIRE 164M

3/16/2024 50%GV 50%AN BLACK/POLLED

GAR SURE FIRE  
CSG SURE FIRE 45G  
CSG 22E  
POST ROCK STOCKADE 183A8  
CSG 39C  
CSG 26Z

BW	84
ADJ. WW	618

CED	BW	WW	YW	MILK	CREA	MARB
16	1.7	73	120	26		

Lot 61 is a Sure Fire son out of a really nice Stockade cow.

## Lot 62 CSG BLUE SKY 90M

3/1/2024 75%GV 25%AN BLACK/POLLED

BLUES IMPACT 001X  
ZA BLUE SKY 6J ET  
ANNISA 92UET  
CSG GEORGIA 71G  
CSG 2IK  
CSG6F

ADJ. BW	72
WW	662

CED	BW	WW	YW	MILK	CREA	MARB
17	-1.2	69	100	27		

90M is a good 6J son and is out of a Georgia daughter. He is a moderate frame and as thick as you could make one.

## Lot 63 CSG LEGENDARY 137M

4/1/2024 50%GV 50%AN BLACK/POLLED

CONNEALY LEGENDARY 644  
DEEP CREEK LEGENDARY 1049  
MS DEEP CREEK WANHEDA 8049  
POST ROCK BAL 321Y8  
CSG MISS CHUNKY 37B  
CSG 43T

BW	85
WW	562

CED	BW	WW	YW	MILK	CREA	MARB
11	1.3	72	118	28		

137M is a son of Legendary. Legendary is an angus bull we bought at the midland bull test. He sires long bodied eye appealing cattle with good growth. He is out of a really nice balancer cow.

## Lot 64 CSG SURE FIRE 107M

3/3/2024 50%GV 50%AN BLACK/POLLED

GAR SURE FIRE  
CSG SURE FIRE 45G  
CSG MISS RESOLUTE 22E  
TL GENERAL  
CSG 9IA  
CSG 6P

BW	84
WW	612

CED	BW	WW	YW	MILK	CREA	MARB
15	-0.2	69	119	24		

107M is a nice Sure Fire bull out of a really good balancer cow.

## Lot 65 ZAK GEORGIA 71M

3/3/2024 75%GV 25%AN BLACK/POLLED

CTR SANDHILLS 0065X  
CSG GEORGIA 71G  
TJB ANNISSA 921U ET  
IMPACT Y353  
CSG IMPACT 9D  
TWILA 26A2

BW	82
WW	594

CED	BW	WW	YW	MILK	CREA	MARB
11	0.4	65	94	20	0.36	0.3

71M is a good thick bull. Sired by 71G and out of an impact Y353 cow. This is a great combination of genetics.



# TWO YEAR OLD BULLS

## 66 *Let* CSG SURE FIRE 168M

3/20/2024 25%GV 75%AN BLACK/POLLED

CSG SURE FIRE 45G  
GAR SURE FIRE  
CSG MISS RESOLUTE 22E  
GAR PREDESTINED  
CSG 40Y  
CSG 1P

BW	84
WW	625

CED	BW	WW	YW	MILK	CREA	MAR.B
14	-1.2	70	118	24	0.41	0.72

168M is a good son of Sure Fire 45G. Out of a really deep bodied Angus cow.

## 67 *Let* CSG SURE FIRE 183M

3/20/2024 75%GV 25%AN BLACK/POLLED

CSG SURE FIRE 45G  
GAR SURE FIRE  
CSG MISS RESOLUTE 22E  
FUTURE INVESTMENT  
CSG 70D  
CSG 9U

ADJ. BW	83
WW	697

CED	BW	WW	YW	MILK	CREA	MAR.B
16	-1.2	74	125	26		

## 68 *Let* CSG DIVIDEND 106M

3/4/2024 99%GV 1%AN BLACK/POLLED

POST ROCK DIVIDEND 86KI ET  
FRONTRUNNER 2510F  
POST ROCK 198L 82F  
CSG BOXCAR WILLIE  
CSG TWILA 26H  
POST ROCK TWILA 26A2

BW	78
WW	658

CED	BW	WW	YW	MILK	CREA	MAR.B
12	1	80	125	25	0.35	0.45

106M A Dividend son here and out of one of my favorite cow families.

## 69 *Let* CSG BLUE SKY 91M

3/1/2024 75%GV 25%AN BLACK/POLLED

ZA BLUE SKY 6J ET  
BLUE'S IMPACT 001X  
TJB ANISSA 921U ET  
CSG SURE FIRE 45G  
CSG 138K  
CSG 54D

ADJ. BW	74
ADJ. WW	621

CED	BW	WW	YW	MILK	CREA	MAR.B
12	-1	65	96	21	368	0.15

91m Sired by our heifer bull 6J, that is producing the right kind. Out of a Sure fire daughter. good genetics here.

## 70 *Let* CSG GEORGIA 176M

3/28/2024 50%GV 50%AN BLACK/POLLED

CSG GEORGIA 71G  
CTR SANDHILLS 0065X  
TJB ANISSA 921U ET  
POST ROCK SUPER TRACKER 76B1  
CSG RIGBY 5G  
CSG 4C

ADJ. BW	80
ADJ. WW	648

CED	BW	WW	YW	MILK	CREA	MAR.B
10	0.8	65	98	21	0.34	0.3

176M is sired by 71G and out of a good moderate frame cow that is an easy keeper.



# TWO YEAR OLD BULLS

## Lot 71 CSG LEGENDARY 165M

3/26/2024 100%AN BLACK/POLLED

CONNEALY LEGENDARY 644  
DEEP CREEK LEGENDARY 1049  
DEEP CREEK WANHEDA 8049  
SCR GENERAL

CSG 86A

MELLING 329

BW	78
WW	682

CED	BW	WW	YW	MILK	CREA	MARB
10	1.5	95	153	23	1.25	0.9

165M's Mother is a full Angus cow with a great udder and fertility. 165M is sired by Legendary.

## Lot 72 CSG LEGENDARY 190M

4/5/2024 50%GV 50%AN BLACK/POLLED

CONNEALY LEGENDARY 644  
DEEP CREEK LEGENDARY 1049  
DEEP CREEK WANHEDA 8049  
POST ROCK WESTERN 143Y1

CSG 21C

CSG 17T

BW	84
WW	688

CED	BW	WW	YW	MILK	CREA	MARB
9	0.9	90	156	23	1.01	0.82

190M is a Legendary son out of a good moderate Gelbvieh cow. This Balancer combination will add more pounds to your weaning weights.

## Lot 73 CSG LEGENDARY 155M

3/20/2024 50%GV 50%AN BLACK/POLLED

CONNEALY LEGENDARY 644  
DEEP CREEK LEGENDARY 1049  
DEEP CREEK WANHEDA 8049  
POST ROCK SUPER TRACKER 76B1

CSG 13E

CSG 46SA

BW	83
WW	710

CED	BW	WW	YW	MILK	CREA	MARB
8	1.9	96	161	22	1.15	0.84

155M is a Legendary son and out of an attractive young cow.

## Lot 74 CSG GEORGIA 128M

3/8/2024 75%GV 25%AN BLACK/POLLED

CTR SANDHILLS 0065X  
CSG GEORGIA 71G  
TJB ANISSA 921U ET  
TEASDALE 918S

CSG 78Y

CSG 5S

BW	76
WW	675

CED	BW	WW	YW	MILK	CREA	MARB
11	0.4	61	89	24	0.35	0.31

128M is a Georgia son out of a 15 year old cow 78y. The Gelbvieh longevity is worth a lot.



# HEIFERS

We have 2 groups of 4 heifers. We will put one group in the ring at a time. The first high bidder can take one heifer or all the heifers or any number between at that price times the number he wants. The second high bidder may do the same. If there are any left of that group the third high bidder takes all that are left.

## Group 1

*Lot*  
**75**

**CSG 68N**

2/14/2025 50%GV 50%AN BLACK/POLLED

BW	69
WW	566

CSG SURE FIRE 45G  
GAR SURE FIRE  
CSG MISS RESOLUTE 22E  
CSG GEORGIA 71G ET  
CSG 26J  
CSG 16F

*Lot*  
**76**

**CSG 72N**

2/14/2025 25%GV 75%AN BLACK/POLLED

BW	72
WW	643

DEEP CREEK SASQUATCH 31I3  
MHA STELLAR J73  
DEEP CREEK MISS RIPPER 1131  
DCFS POST ROCK ASTRONAUT 122F1  
CSG 2K  
CSG 40Y

*Lot*  
**77**

**CSG 178N**

3/30/2025 75%GV 25%AN BLACK/POLLED

BW	75
WW	564

DCSF POST ROCK BLK BAL 107L8  
EGL GAME CHANGER D136  
POST ROCK WILMA 118G8  
WESTERH HAULER  
CSG 21E  
CSG 30Y

*Lot*  
**78**

**CSG 201N**

3/20/2025 25%GV 75%AN BLACK/POLLED

BW	80
WW	522

DEEP CREEK SASQUATCH 31I3  
MHA STELLAR J73  
DEEP CREEK MISS RIPPER 1131  
CSG SURE FIRE 45G  
CSG 11H  
CSG 13K

## Group 2

*Lot*  
**79**

**CSG 65N**

2/14/2025 50%GV 50%AN BLACK/POLLED

BW	82
WW	706

CSG SURE FIRE 45G  
GAR SURE FIRE  
CSG 22E  
TRACTION  
CSG 17F  
CSG 36Z

*Lot*  
**80**

**CSG 97N**

2/15/2025 50%GV 50%AN BLACK/POLLED

BW	76
WW	504

TAYD 321A SAND TRAP 206K ET  
SAND TRAP ET  
LADY GRANITE 321A ET  
CSG BI27  
CSG Y127

*Lot*  
**81**

**CSG 107N**

2/24/2025 50%GV 50%AN BLACK/POLLED

BW	70
WW	586

DEEP CREEK SASQUATCH 31I3  
MHA STELLAR J73  
DEEP CREEK MISS RIPPER 1131  
FRONT RUNNER  
CSG WANDA 82K  
CSG WANDA 107Y

*Lot*  
**82**

**CSG 118N**

2/25/2025 50%GV 50%AN BLACK/POLLED

BW	78
WW	536

DEEP CREEK SASQUATCH 31I3  
MHA STELLAR J73  
DEEP CREEK MISS RIPPER 1131  
CSG GEORGIA 71G ET  
CSG 45K  
CSG 35G



# *First Season Death and Injury Warranty*

Sheridan Ranch has offered to share death and injury losses suffered during the first breeding season with customers for years. After some confusion over the old warranty and interest by many customers to cover the full cost of their purchases at a reasonable cost we have initiated the following new warranty.

## **COVERAGE/LIMITATIONS**

The coverage of this warranty is limited to the first breeding season or a maximum of 6 months from the date of purchase, unless other arrangements are made ahead of time. Indemnity under this warranty covers all death and loss-of-use injuries except those caused by negligence or willful misconduct or mistreatment of the bulls covered. Replacement value will be limited to actual purchase cost of the Sheridan Ranch bull covered minus any salvage value or other compensation received by the customer.

**CLAIMS** All claims for death or injury must be reported to Sheridan Ranch within 48 hours of discovery and a complete diagnosis by a licensed veterinarian must be reported.

**INJURED** If the injury is not life threatening or permanent and the bull can be returned to service Sheridan Ranch will work with the customer to supply a replacement bull to use at no cost, until the original bull can be returned to service.

**LOSS DUE TO INJURY** If the injury is permanent and prevents the bull from returning to service, Sheridan Ranch will supply a replacement bull as close to the original bulls type and quality as possible to complete the first breeding season. At the end of the breeding season the customer can keep the bull as the replacement bull as fulfillment of this warranty or return him to Sheridan Ranch and receive credit on a replacement in next years sale. The credit will equal the price of the original bull minus salvage value if any from the original bull. The customer agrees to provide humane care and obtain maximum salvage value from the injured bull. This guarantees the customer a bull to get their cows bred and full compensation for the purchase price of the bull through a replacement they get to pick and price.

**LOSS DUE TO DEATH** When a Sheridan Ranch bull dies between the date of purchase and the end of the first breeding season, through no fault of the customer as described above, Sheridan Ranch will supply a replacement bull, as close to the original bull's type and quality as possible, to finish out the breeding season. At the end of the breeding season, the customer can either keep the replacement bull as fulfillment of this warranty or return him to Sheridan Ranch and receive credit on a replacement in next year's sale. This credit will equal the purchase price of the original bull minus any compensation received if insured by an insurance company. This guarantees the customer a bull to get their cows bred and full compensation for the purchase price of the bull through a replacement they get to pick and price.

**COST** Cost for the death and injury warranty will be 4% of purchase price, due at the time of purchase. If a customer chooses not to cover their animal against death and injury, they assume all loss due to death or injury of their bull. This warranty does not affect other customer services like the customer satisfaction.

SHERIDAN RANCH SALE  
PO BOX 184  
ALMO, IDAHO 83312  
208-430-5532

TO: